

850X6 LAMA PROFİL

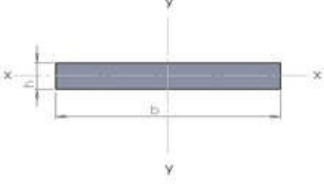

PULTECH FRP CTP YAPI PROFİLLERİ

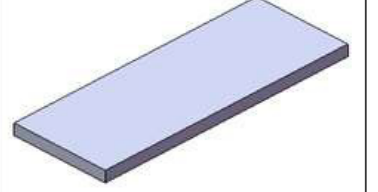

A= kesit alanı

G= Birim boy ağırlığı

I= Atalet momenti

W= mukavemet momenti

r= Atalet yarıçapı

PROFİL KODU	PROFİL EBATLARI				A (mm ²)	G (gr/mt)	EĞİLME EKSENİ					
	b(mm)	h(mm)	r1(mm)	r2(mm)			X-X EKSENİ			Y-Y EKSENİ		
							I(mm ⁴)	W(mm ³)	r(mm)	I(mm ⁴)	W(mm ³)	r(mm)
FRP LM14	850	6			5100	9180	15300	5100,0	1,73	307062500	722500,0	245,4

ÖZELLİKLER / PROPERTIES

Mechanical	Test Method	Units	Min. Value
Tensile Stress (LW)	ASTM D638 / EN ISO 527 - 4	MPa	137,9 / 240
Tensile Stress (CW)	ASTM D638 / EN ISO 527 - 4	MPa	68,9 / 50
Tensile Modulus (LW)	ASTM D638 / EN ISO 527 - 4	GPa	12,4 / 23
Tensile Modulus (CW)	ASTM D638 / EN ISO 527 - 4	GPa	6,2 / 7
Compressive Strength (LW)	ASTM D695	MPa	165,4
Compressive Strength (CW)	ASTM D695	MPa	113,7
Compressive Modulus (LW)	ASTM D695	GPa	12,4
Compressive Modulus (CW)	ASTM D695	GPa	6,9
Flexural Strength (LW)	ASTM D790 / EN ISO 14125	MPa	241,3 / 240
Flexural Strength (CW)	ASTM D790 / EN ISO 14125	MPa	103,4 / 100
Flexural Modulus (LW)	ASTM D790	GPa	13,8
Flexural Modulus (CW)	ASTM D790	GPa	7,6
Modulus of Elasticity	Full Section / Annex D, EN ISO 13706 - 2	GPa	-
Shear Modulus	Full Section	GPa	-
Interlaminar Shear (LW)	ASTM D2344 / EN ISO 14130	MPa	- / 25
Notched Izod Impact (LW)	ASTM D256	J/mm	1,02
Notched Izod Impact (CW)	ASTM D256	J/mm	0,26
Bearing Strength (LW)	ASTM D953 / Annex E, EN 13706 - 2	MPa	220,6 / 150
Bearing Strength (CW)	ASTM D953 / Annex E, EN 13706 - 2	MPa	220,6 / 70
Poisson's Ratio (LW)	ASTM D3039	-	0,31

(LW) = Lengthwise, (CW) = Crosswise, (PF) = Perpendicular to Laminate Face

Physical	Test Method	Units	Min. Value
24hr Water Absorption	ASTM D570 / EN ISO 62	% by wt	0,6 / 0,4
Barcol Hardness	ASTM D2583	-	40
Density	ASTM D792 / EN ISO 1183	gr/cm ³	1,66 - 1,88 / 1,71 - 1,93