

25X5 LAMA PROFİL

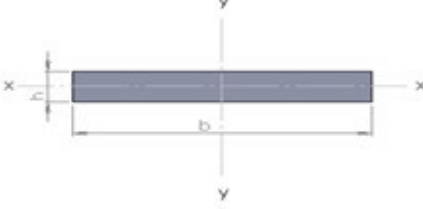

PULTECH FRP CTP YAPI PROFİLLERİ

A= kesit alanı

G= Birim boy ağırlığı

I= Atalet momenti

W= mukavemet momenti

r= Atalet yarıçapı

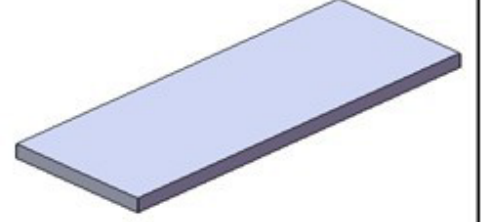

PROFİL KODU	PROFİL EBATLARI		A (mm ²)	G (gr/m)	EĞİLME EKSENİ VE KESİT ÖZELLİKLERİ					
	b(mm)	h(mm)			X-X EKSENİ			Y-Y EKSENİ		
					I(mm ⁴)	W(mm ³)	r(mm)	I(mm ⁴)	W(mm ³)	r(mm)
FRP-LM-015	25	5	125	225	260,42	104,2	1,44	6510,42	520,8	7,2

ÖZELLİKLER / PROPERTIES

Mechanical				
	Test Method		Units	Min. Value
Tensile Stress (LW)	ASTM D638 / EN ISO 527	- 4	MPa	137,9 / 240
Tensile Stress (CW)	ASTM D638 / EN ISO 527	- 4	MPa	-
Tensile Modulus (LW)	ASTM D638 / EN ISO 527	- 4	GPa	12,4 / 23
Tensile Modulus (CW)	ASTM D638 / EN ISO 527	- 4	GPa	-
Compressive Strength (LW)	ASTM D695		MPa	165,4
Compressive Strength (CW)	ASTM D695		MPa	113,7
Compressive Modulus (LW)	ASTM D695		GPa	12,4
Compressive Modulus (CW)	ASTM D695		GPa	6,9
Flexural Strength (LW)	ASTM D790 / EN ISO 14125		MPa	241,3 / 240
Flexural Strength (CW)	ASTM D790 / EN ISO 14125		MPa	-
Flexural Modulus (LW)	ASTM D790		GPa	13,8
Flexural Modulus (CW)	ASTM D790		GPa	-
Modulus of Elasticity	Full Section / Annex D, EN ISO 13706 - 2		GPa	-
Shear Modulus	Full Section		GPa	-
Interlaminar Shear (LW)	ASTM D2344 / EN ISO 14130		MPa	-
Notched Izod Impact (LW)	ASTM D256		J/mm	1,02
Notched Izod Impact (CW)	ASTM D256		J/mm	0,26
Bearing Strength (LW)	ASTM D953 / Annex E, EN 13706 - 2		MPa	220,6 / 150
Bearing Strength (CW)	ASTM D953 / Annex E, EN 13706 - 2		MPa	-
Poisson's Ratio (LW)	ASTM D3039		-	0,31

(LW) = Lengthwise, (CW) = Crosswise, (PF) = Perpendicular to Laminate Face

Physical				
	Test Method		Units	Min. Value
24hr Water Absorption	ASTM D570 / EN ISO 62		% by wt	0,6 / 0,4
Barcol Hardness	ASTM D2583		-	40
Density	ASTM D792 / EN ISO 1183		gr/cm ³	1,66 - 1,88 / 1,71 - 1,93